

Items Included:

- Case 1pc
- Eyelids with Eyelashes 3set
for right eye (Display as 右) 3pcs
for left eye (Display as 左) 3pcs
- Instruction manual 1pc

*Note: Please check to see if the product has any initial defects.
If you find any initial defects in the product,
please contact the dealer.*

Skill Taught:

- Attach to the eyelashes
- makeup and cleansing

Note: Please don't modify this product.

Technical Specifications:

Material:

- Eyelids Urethane elastomer
- Eyelashes Human hair

Environmental:

1. Please storage this product at room temperature.
Keep it in the room you live.
2. Please avoid direct sunlight.
3. Please keep this product away from the fire.

Disposal method:

Follow the laws and regulations of the country / region where you want to dispose of it.

Instruction Manual

BE-306

Eyelids with Eyelashes

Our products are made of artificial skin "BIODY" .



Cautions and Warnings

1. This product contains Urethane which may cause allergic reactions when in contact with humans.
2. Keep out of reach of children. There is a risk that children may eat eyelids with eyelashes.
3. This product is made of urethane material.
Please stop using immediately, if you feel uncomfourt during use it.

© 2021 Regina Fashion Supply Co.,Ltd. All right reserved.
Manufacturer Regina Fashion Supply Co.,Ltd.
No.3-10-2,Takasago,Urawa-ku,Saitama-City,
Saitama-Prefecture, Japan.

T:(+81)48 836 2600

www.regina-biody.com

2021-05
Rev. 3.1

Directions for Use:

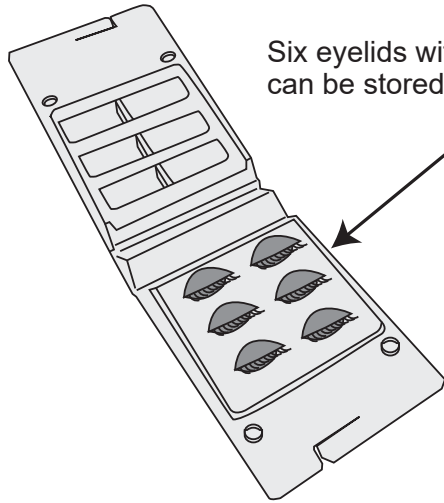

Six eyelids with eyelashes can be stored in the case.

To keep eyelids with eyelashes from falling out, don't tilt with the case lid open.

You can display eyelids with eyelashes by rotating the case lid.

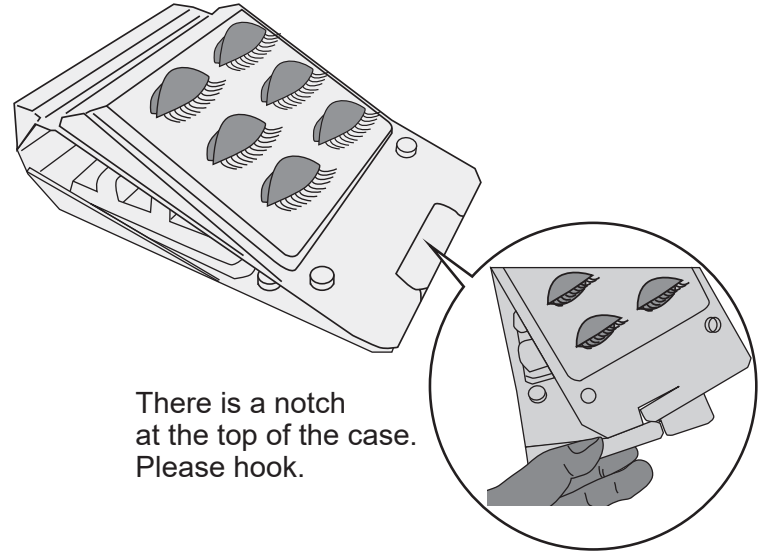

There is a notch at the top of the case. Please hook.

Care and Maintenance:

1. Don't press hard on modules.
2. Don't place heavy objects on modules.
3. Please remove makeup after use.
4. Color doesn't disappear when using oil-based markers.
5. Don't expose to hot water more than 60 °C.
6. If the skin of modules becomes dirty, clean the stain with ethanol.
7. Organic solvents such as thinner, chloroform, acid chemicals, and alkali chemicals cannot be used.

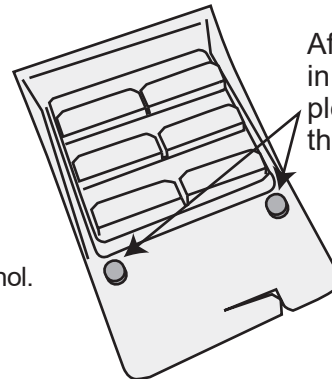

After putting eyelids with eyelashes in the case, please press convex part to lock the lid of the case.